

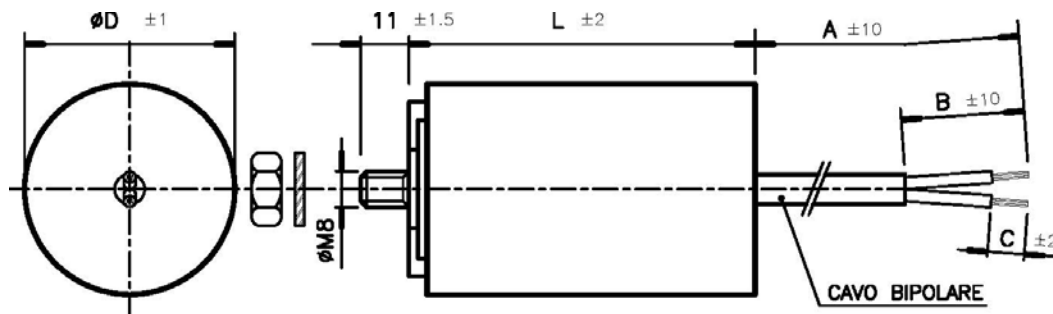

**MOTOR CAPACITORS  
SERIES MLR 25 PRL.....**



L = 71mm  
D = 35mm  
A = 350mm

B = 35mm  
C = 10mm

	Modell	ECOFILL MLR 25 PRL 451003571/MK SH
1	Dielectric	METALLIZED POLYPROPYLENE
2	Filling	RESIN
3	Case material	Thermoplastic Self-Estinguish V2" Class
4	Capacitance / Tolerance	10 $\mu$ F $\pm$ 5%
5	Rated frequency	50 Hz – 60 Hz
6	Rated voltage	a) AC 400 V 1 $\mu$ F ...45 $\mu$ F b) AC 450 V 1 $\mu$ F ...45 $\mu$ F c) AC 500 V 1 $\mu$ F ...45 $\mu$ F
7	Type of operation	DB
8	Life expectanca	a) A b)B c) D
9	Class of operation	a) 30.000 h b) 10.000 h c) 1.000 h
10	Climatic Category	40/085/21
11	Class of safety protection	S0
12	Test Voltage between terminals	2,15 U <sub>N</sub> x 2"
13	Test Voltage between terminals to case	2.500 V x 2"
14	Insulating Resistance between terminals	10 x 10 <sup>3</sup> M $\Omega$ x $\mu$ F
15	Tan $\delta$	$\leq$ 5 x 10 <sup>-4</sup>
16	DV/dt (typical)	10 V/ $\mu$ s
17	Tested and Certified according to	EN 60252-1 : 2014
18	Certification marks	VDE